

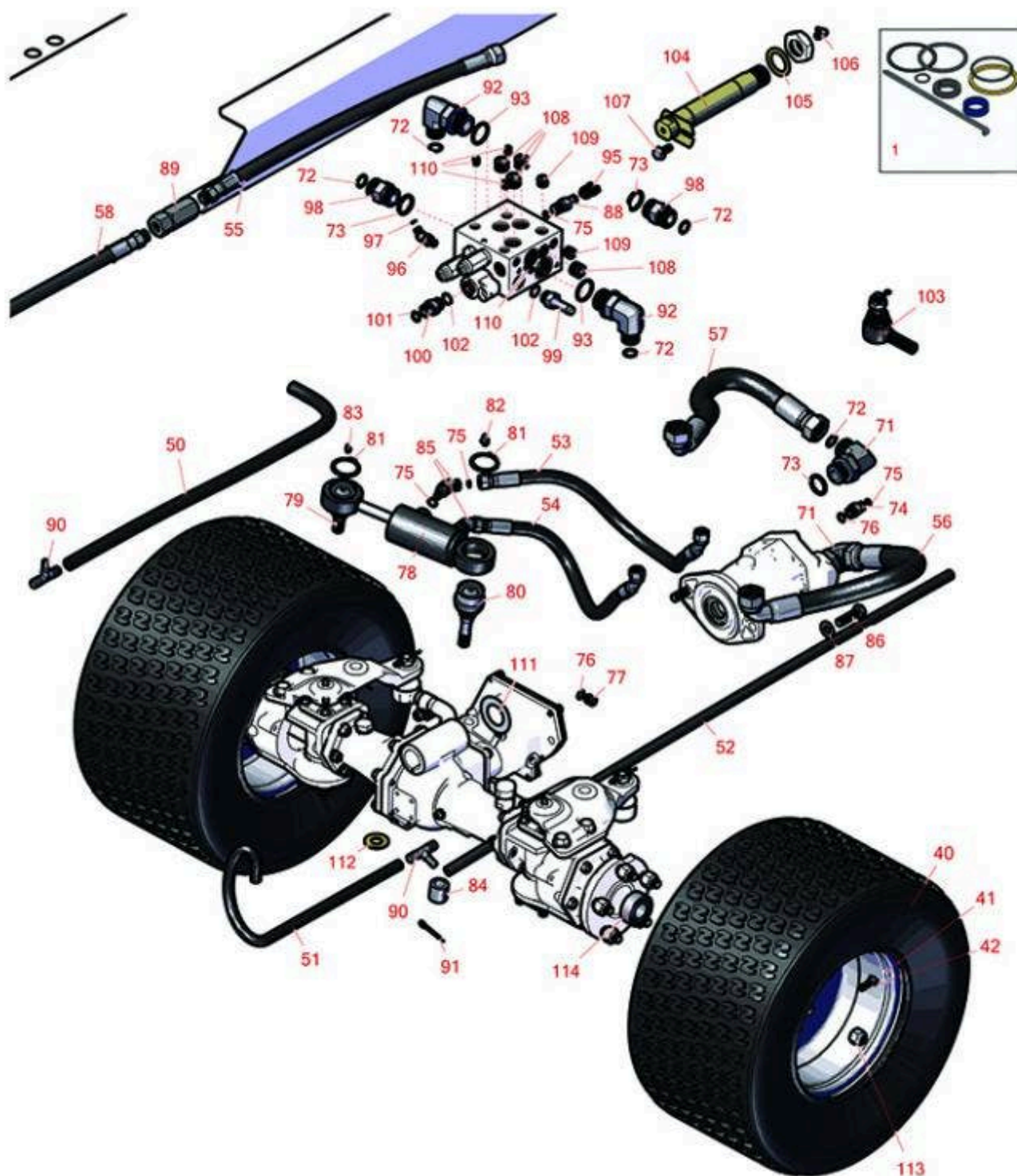

# Replaces Toro Groundsmaster 4000-D Parts

Rotary Mower - Model 30412  
Rear Wheels



All original equipment manufacturers names and part numbers are used for identification purposes only, and we are in no way implying that our products are original equipment parts. Prices subject to change without notice.



# Replaces Toro Groundsmaster 4000-D Parts

Rotary Mower - Model 30412  
Rear Wheels



Item No	R&R Part No.	OEM Part No.	Description	Qty Req	Order Quantity
---------	--------------	--------------	-------------	---------	----------------

## Overhaul Kits and Service Tools

1	<b>R107-0245</b>	107-0245	Seal Kit - Fits R105-0775 Hyd Cyl	1	
---	------------------	----------	-----------------------------------	---	--

## Tires

40	<b>RCT6L07411</b>		Tire - 20x10-10 6 Ply Turf Master	2	
----	-------------------	--	-----------------------------------	---	--

*Detail Description: The Carlisle Turf Master tire is a professional-grade tire known for its durability, stability, and traction. With its contoured shoulder protection, deep tread lugs, and durable compound, the Turf Master tire delivers reliable performance for ZTRs and professional-grade mowers. Whether you're maintaining a large lawn or operating a commercial landscaping business, the Turf Master tire is designed to meet your high standards and exceed your expectations.:*

41	<b>R100-2582</b>	100-2582, 120-8909, 217-120, 217-125	Rim - Rear Tire 10 x 7	2	
----	------------------	---	------------------------	---	--

42	<b>R232-27</b>	232-27, 232-31	Stem - Valve w/ Cap	2	
----	----------------	-------------------	---------------------	---	--

## Hoses

50	<b>R110-6153</b>	110-6153	Hose	1	
51	<b>R100-5607</b>	100-5607	Hose	1	
52	<b>R115-8466</b>	115-8466	Hose	1	
53	<b>R92-7538</b>	92-7538	Hydraulic Hose Assy	1	
54	<b>R92-7539</b>	92-7539	Hydraulic Hose Assy	1	
55	<b>R100-5617</b>	100-5617	Hydraulic Hose Assy	1	
56	<b>R100-5579</b>	100-5579	Hydraulic Hose Assy	1	
57	<b>R104-3502</b>	104-3502	Hydraulic Hose Assy	1	
58	<b>R104-2237</b>	104-2237	Hydraulic Hose Assy	1	

## Other Parts Available

All original equipment manufacturers names and part numbers are used for identification purposes only, and we are in no way implying that our products are original equipment parts. Prices subject to change without notice.



# Replaces Toro Groundsmaster 4000-D Parts

*Rotary Mower - Model 30412  
Rear Wheels*



Item No	R&R Part No.	OEM Part No.	Description	Qty Req	Order Quantity
71	<b>R340-142</b>	340-142, 95-1692	Hydraulic Fitting - 90 Deg	2	
72	<b>R237-58</b>	237-58	O-Ring	6	
73	<b>R237-81</b>	237-81, 237.81, 327-81	O-Ring	4	
74	<b>R340-2</b>	340-2, 60-1920	Hydraulic Fitting - Striaight	1	
75	<b>R237-22</b>	107-8844, 237-22, 237-78	O-Ring	6	
76	<b>R237-42</b>	237-42, 31-4160	O-Ring	2	
77	<b>R353-989</b>	353-989	Plug - Hex - Hollow	1	
78	<b>R105-0775</b>	105-0775	Steering Cylinder	1	
79	<b>R106-6774</b>	106-6774, 92-5838, 92-5838-01	Ball Joint	1	
80	<b>R100-3795</b>	100-3795	Ball Joint	1	
81	<b>R32151-104</b>	32151-104	Ring - Retaining, Ex	2	
82	<b>R302-60</b>	302-60	Zerk - Grease 90 Deg.	1	

All original equipment manufacturers names and part numbers are used for identification purposes only, and we are in no way implying that our products are original equipment parts. Prices subject to change without notice.



# Replaces Toro Groundsmaster 4000-D Parts

Rotary Mower - Model 30412  
Rear Wheels



Item No	R&R Part No.	OEM Part No.	Description	Qty Req	Order Quantity
83	R302-5	21-6010, 302-11, 302-37, 302-47, 302-5, 302-57, 302-58, 302-6, 31-0300, 32-9660, 60-0800, 62-3880, 92-4181	Fitting - Grease	3	
84	R100-3796	100-3796	Spacer - Ball Joint	1	
85	R340-54	340-54	Fitting - Elbow - 45 Deg	2	
86	R325-7	01-150-0380, 01-178-0814, 3226-3, 325-7, 48-9490	Bolt - 1/2-13 x 1 3/4 Hex HD Gr 5	2	
87	R3256-26	01-166-0540, 01-166-0820, 17-2530, 24-13-BD, 30-8570, 3256-26, 356206, 48-9390	Washer - 1/2 in	2	
88	R354-77	354-77	Fitting-Quick	1	
89	R100-5600	100-5600	Valve-Check	1	
90	R99-7371	99-7371	Connector-Tee	3	
91	R3272-12	01-151-0090, 28-19-D, 3272-12	Pin - Cotter 1/8 x 1-1/4	1	
92	R340-15	340-15	Hydraulic Fitting - 90 Deg	2	

All original equipment manufacturers names and part numbers are used for identification purposes only, and we are in no way implying that our products are original equipment parts. Prices subject to change without notice.



# Replaces Toro Groundsmaster 4000-D Parts

*Rotary Mower - Model 30412  
Rear Wheels*



Item No	R&R Part No.	OEM Part No.	Description	Qty Req	Order Quantity
93	<b>R237-146</b>	237-146, 340-146	O-Ring	2	
95	<b>R354-79</b>	354-79	Cap-Dust	1	
96	<b>R340-103</b>	340-103, 340-137	Hydraulic Fitting - 45 Deg	2	
97	<b>R237-21</b>	237-21, 327-21	O-Ring	1	
98	<b>R340-9</b>	340-9	Fitting - Straight Connector	2	
99	<b>R354-121</b>	354-121, 92-1665	Fitting-Straight	1	
100	<b>R340-4</b>	340-4	Hydraulic Fitting - Male Connector	1	
101	<b>R237-30</b>	23-6320, 237-30	O-Ring - Seal	1	
102	<b>R237-79</b>	237-79	O-Ring	2	
103	<b>R106-1113</b>	100-3852, 106-1113	Tie Rod End Assy RH Thread	2	
104	<b>R98-7077</b>	98-7077	Axle Pin - Rear	1	
105	<b>R92-1765</b>	92-1765	Washer - Thrust	1	
106	<b>R323016</b>	302-33, 323016	1/8"-NPT 90 Degree Grease Fitting	1	
107	<b>R32144-14</b>	32104-32, 32104-49, 32144-14	Bolt - Hex Washer 5/16-18 x 5/8	1	
108	<b>R106-1027</b>	106-1027	Plug-Hyd	5	
109	<b>R106-1026</b>	106-1026	Plug-Hyd	4	
110	<b>R106-1025</b>	106-1025	Plug - Hyd	5	

All original equipment manufacturers names and part numbers are used for identification purposes only, and we are in no way implying that our products are original equipment parts. Prices subject to change without notice.



# Replaces Toro Groundsmaster 4000-D Parts

*Rotary Mower - Model 30412  
Rear Wheels*



Item No	R&R Part No.	OEM Part No.	Description	Qty Req	Order Quantity
111	<b>R99-8432</b>	99-8432	Washer - Thrust	2	
112	<b>R92-5836</b>	92-5836	Flat Washer - Hardened	1	
113	<b>R93-5268</b>	93-5268	Nut - M12-1.5 Wheel	10	
114	<b>R99-7534</b>	99-7534	Bearing - Double Row Ball	2	

All original equipment manufacturers names and part numbers are used for identification purposes only, and we are in no way implying that our products are original equipment parts. Prices subject to change without notice.