

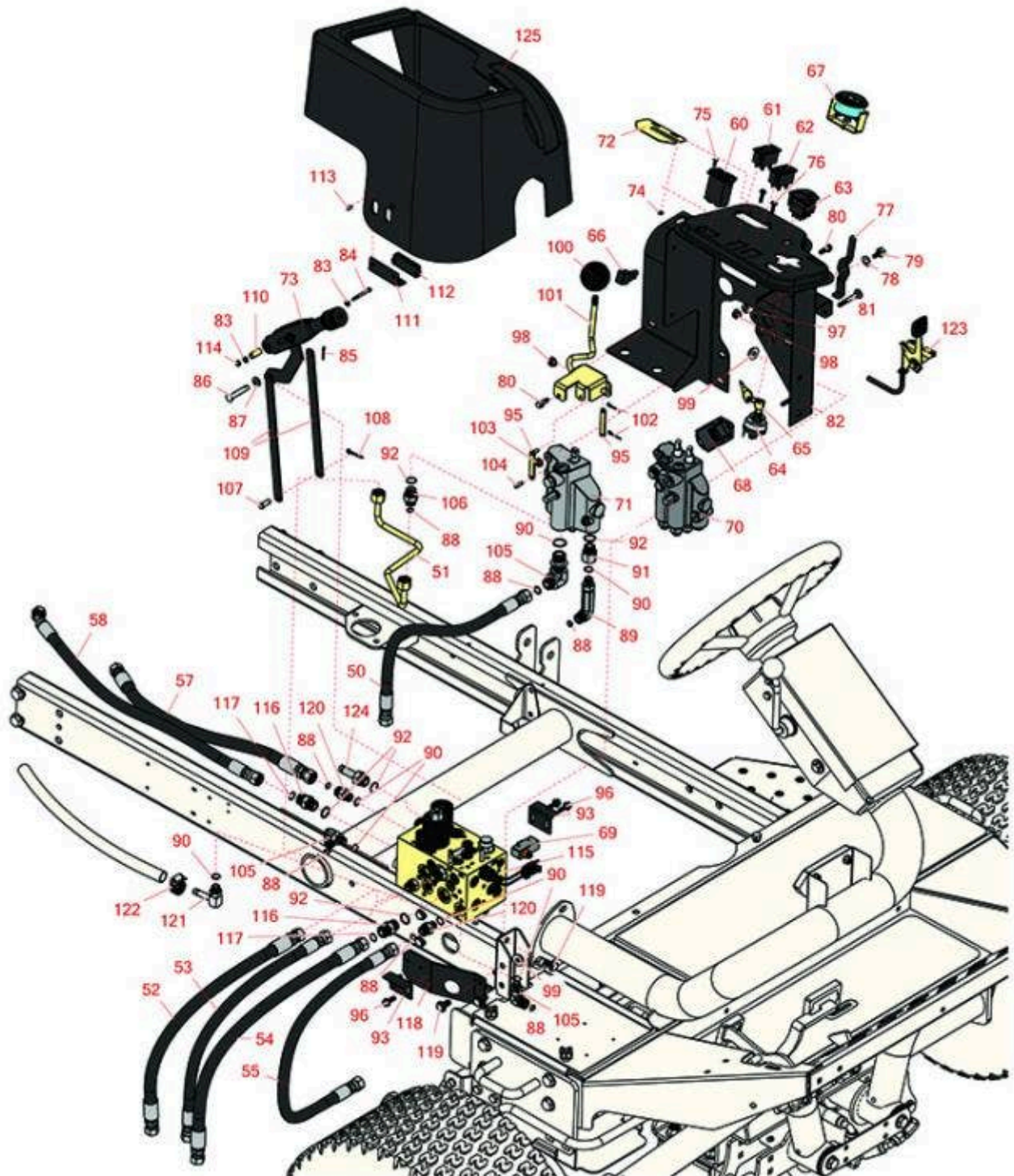

Replaces Toro Reelmaster 3100-D Parts

Traction Unit - Model 03201

Control Panel, Hyd Valve & Parking Brake



All original equipment manufacturers names and part numbers are used for identification purposes only, and we are in no way implying that our products are original equipment parts. Prices subject to change without notice.



Replaces Toro Reelmaster 3100-D Parts

Traction Unit - Model 03201

Control Panel, Hyd Valve & Parking Brake



Item No	R&R Part No.	OEM Part No.	Description	Qty Req	Order Quantity
Hoses					
50	R99-3575	99-3575	Hydraulic Hose Assy	1	
51	R99-3551	99-3551	Tube Assy	1	
52	R99-3578	99-3578	Hydraulic Hose Assy	1	
53	R99-3577	69-5860, 99-3577	Hydraulic Hose Assy	1	
54	R99-3574	99-3574	Hydraulic Hose Assy	1	
55	R99-3576	99-3576	Hydraulic Hose Assy	1	
57	R95-8829	95-8829	Hydraulic Hose Assy	1	
58	R106-4197	106-4197	Hydraulic Hose Assy	1	
Gauges and Controls					
60	R75-6820	75-6820	Meter - Hour - Quartz	1	
61	R100-8071	100-8071	Lamp - Warning	1	
62	R100-8070	100-8070	Lamp - Warning	1	
63	R95-8999	95-8999	Switch - Headlight	1	
64	R104-2541	104-2541, 88-9830	Switch - Key 6 Lead 5/8 Mt.	1	
65	R343060	218-412, 32-8380, 33-2010, 62-7770, 63-8360, 94-2618	Ignition - Key Set/2	1	
66	R100-4918	100-4818, 100-4918	Diode	1	
67	R93-7053	87-4140, 93-7053	Cluster - Lamp Warning	1	

All original equipment manufacturers names and part numbers are used for identification purposes only, and we are in no way implying that our products are original equipment parts. Prices subject to change without notice.



Replaces Toro Reelmaster 3100-D Parts

Traction Unit - Model 03201

Control Panel, Hyd Valve & Parking Brake



Item No	R&R Part No.	OEM Part No.	Description	Qty Req	Order Quantity
68	RX1709565660	98-7611, 99-3463, 99-7611	Kubota Controller	1	
69	R29-6162	29-6161, 29-6162	Switch - Micro	1	
70	R95-8581	95-8581	Valve- Assy - 2 Spool	1	
71	R95-8689	95-8689	Valve Assy - Control - Single Spool	1	
Other Parts Available					
72	R104-0421	104-0421	Plate - Throttle Stop	1	
73	R104-4817	104-4817	Lever - Brake	1	
74	R3290-148	3290-148	Nut - 10-24 Fl Lock	2	
75	R32144-18	32144-18	Screw - Hex HD	2	
76	R32105-13	32105-13	Screw - Hx Was HD 10-32 x 3/4	2	
77	R99-3401-03	99-3401, 99-3401-03	Lever - Valve - Lock	1	
78	R3290-477	108473, 3290-477	Washer - Spring Wave	1	
79	R63-3410	63-3410	Screw - Shoulder	1	
80	R42-3560	42-3560	Bolt-Shoulder	2	
81	R3230-33	3230-33	Screw - Carriage	2	
82	R104-5190-03	104-5190-03	Panel - Control	1	
83	R150426	3256-21	Washer - 8 SAE	2	
84	R32105-9	32105-9	Screw	1	

All original equipment manufacturers names and part numbers are used for identification purposes only, and we are in no way implying that our products are original equipment parts. Prices subject to change without notice.



Replaces Toro Reelmaster 3100-D Parts

Traction Unit - Model 03201

Control Panel, Hyd Valve & Parking Brake



Item No	R&R Part No.	OEM Part No.	Description	Qty Req	Order Quantity
85	R1023-4	01-151-0150, 1023-4, 19-6220, 214-14, 215-54, 28-9-D, 3272-4, 3272-6, 513567, 932008P	Pin - Cotter 3/32 x 3/4	1	
86	R94-3829	94-3829	Pin - Clevis	1	
87	R453009	01-166-0400, 24-10-BD, 24-9-AD, 32-9650, 3256-2, 3256-23, 3256-3, 3256-67, 3290-217, 3556-3, 4-2390, 7-0152	Washer - Flat 5/16 SAE	1	
88	R237-22	107-8844, 237-22, 237-78	O-Ring	5	
89	R69-4320	69-4320	Hydraulic Fitting - 90 Deg	1	
90	R237-42	237-42, 31-4160	O-Ring	4	
91	R353-397	353-397	Reducer - Adapter	1	
92	R237-79	237-79	O-Ring	4	
93	R95-8765	95-8765	Bracket - Magnet Strike	2	
95	R95-8634	95-8634	Link	2	

All original equipment manufacturers names and part numbers are used for identification purposes only, and we are in no way implying that our products are original equipment parts. Prices subject to change without notice.



Replaces Toro Reelmaster 3100-D Parts

Traction Unit - Model 03201

Control Panel, Hyd Valve & Parking Brake



Item No	R&R Part No.	OEM Part No.	Description	Qty Req	Order Quantity
96	R32144-10	32140-81, 32144-10, 32144-3, 34-140-AMVD	Bolt - 1/4-20 x 3/4 Serrated Hx Wshr	4	
97	R3256-22	24-9-BD, 3-1032, 3256-1, 3256-22, 93-0954, 93-0989	Washer - Flat 1/4 Yellow	1	
98	R32128-32	32128-32	Locknut - 1/4-20 Flanged	3	
99	R32128-43	30-8990, 32128-43, 3290-357	Nut - Flanged Whiz - 3/8-16	6	
100	R233-42	1-603175, 120-9752, 233-42, 233-47	Knob	1	
101	R95-8692	95-8692	Lever Assy	1	
102	R3272-5	28-8-D, 3272-5	Pin-Cotter	2	
103	R32128-33	32128-33	Nut - 1/4-20 Flanged Serr	2	
104	R58-3830	58-3830	Pin - Clevis 3/16 x 3/4	2	
105	R340-77	340-100, 340-77, 95-7889	Hydraulic Fitting	3	
106	R340-3	340-3	Hydraulic Fitting - Adapter Connector	1	
107	R283-62	283-62	Pin - Clevis 5/16 x 3/4	1	
108	R3272-10	01-151-0120, 105-7512, 3272-10, N/A	Pin - Cotter 1/8 x 3/4	1	

All original equipment manufacturers names and part numbers are used for identification purposes only, and we are in no way implying that our products are original equipment parts. Prices subject to change without notice.



Replaces Toro Reelmaster 3100-D Parts

Traction Unit - Model 03201

Control Panel, Hyd Valve & Parking Brake



Item No	R&R Part No.	OEM Part No.	Description	Qty Req	Order Quantity
109	R104-4628-03	104-4628-03	Link - Parking Brake	2	
110	R87-4710	87-4710	Spacer - Parking Brake	1	
111	R95-8763	95-8763	Bracket - Hold Down	2	
112	R58-4250	58-4250, 99-3497	Catch - Magnetic	2	
113	R3269-5	3269-5	Rivet - Pop	4	
114	R3296-9	32127-17, 3296-9	Locknut - Comb	1	
115	R108-9037	104-4841, 108-9037	Manifold - Reel Drive	1	
116	R340-4	340-4	Hydraulic Fitting - Male Connector	2	
117	R237-30	23-6320, 237-30	O-Ring - Seal	2	
118	R95-8764-03	95-8764, 95-8764-03	Support - Magnet	1	
119	R3234-1	321-11, 3234-1	Bolt - Flanged Serrated Hex HD 3/8-16 x 3/4	6	
120	R340-2	340-2, 60-1920	Hydraulic Fitting - Striaght	2	
121	R100-4887	100-4887	Fitting-Barb	1	
122	R2412-36	2210-87, 2412-36, 31-9140, 93-5818, 99-0772	Clamp - Hose 1/2	2	
123	R110-8750	110-8750, 95-8855	Throttle Control	1	
124	R354-121	354-121, 92-1665	Fitting-Straight	1	

All original equipment manufacturers names and part numbers are used for identification purposes only, and we are in no way implying that our products are original equipment parts. Prices subject to change without notice.



Replaces Toro Reelmaster 3100-D Parts

Traction Unit - Model 03201

Control Panel, Hyd Valve & Parking Brake

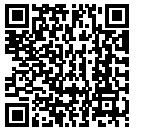

Item No	R&R Part No.	OEM Part No.	Description	Qty Req	Order Quantity
125	R95-8707	95-8707	Cover - Dash	1	

All original equipment manufacturers names and part numbers are used for identification purposes only, and we are in no way implying that our products are original equipment parts. Prices subject to change without notice.