

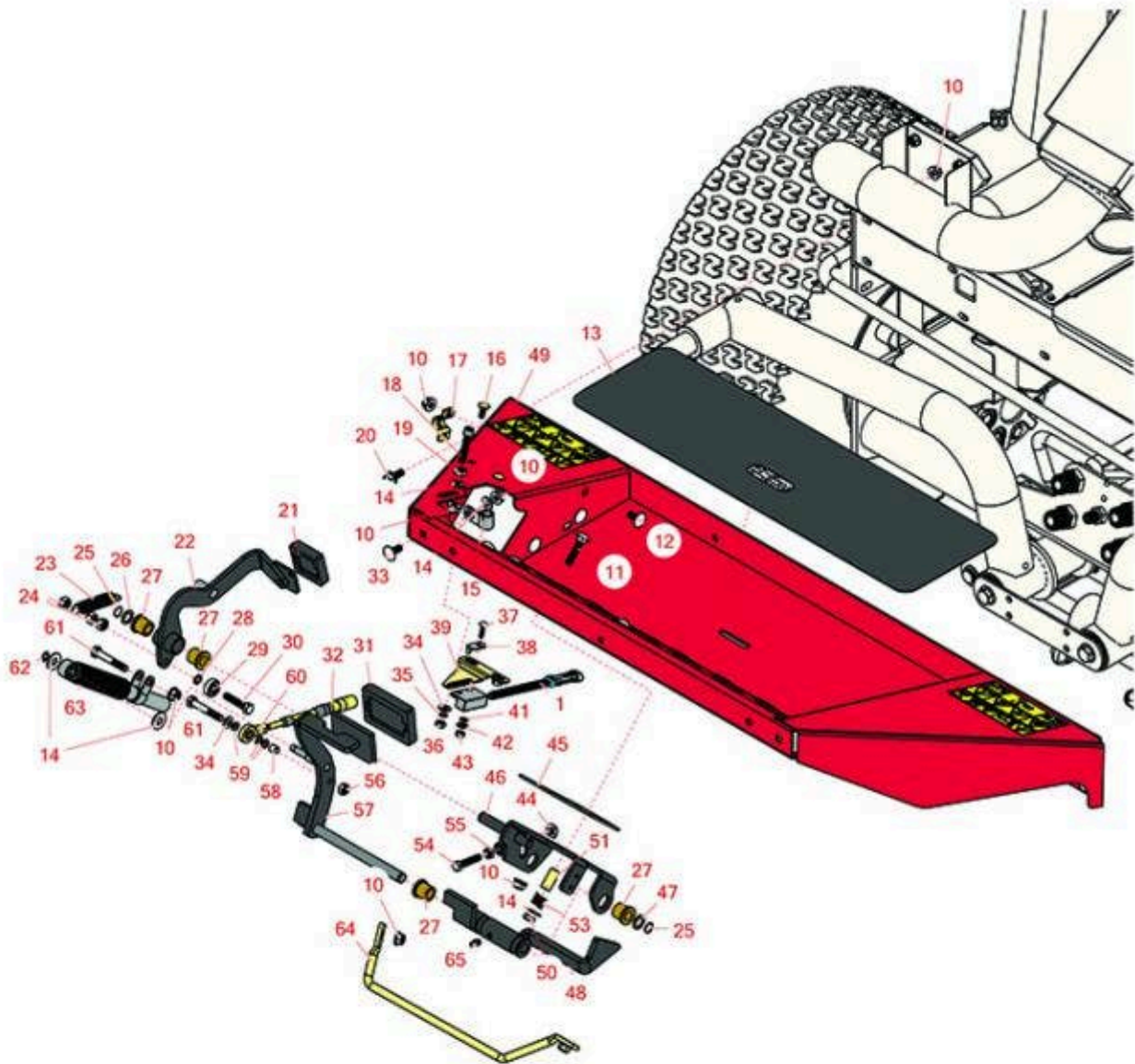

Replaces Toro Reelmaster 3100-D Parts

Traction Unit - Model 03200

Front Platform



All original equipment manufacturers names and part numbers are used for identification purposes only, and we are in no way implying that our products are original equipment parts. Prices subject to change without notice.



Replaces Toro Reelmaster 3100-D Parts

Traction Unit - Model 03200

Front Platform



| Item No | R&R Part No. | OEM Part No. | Description | Qty Req | Order Quantity |
|------------------------------|------------------|--|---------------------------------|---------|----------------|
| Gauges and Controls | | | | | |
| 1 | R100-1270 | 100-1270 | Sensor - Proximity | 1 | |
| Other Parts Available | | | | | |
| 10 | R445722 | 30-8980, 32128-2, 32128-20, 32128-20, 445722 | Nut - Serrated Washer | 15 | |
| 11 | R3230-6 | 3230-6 | Bolt - Carraige | 1 | |
| 12 | R112-6950 | 112-6950, 3230-27 | Bolt - Carriage 5/16-18 x 1-1/2 | 3 | |
| 13 | R99-3478 | 99-3478 | Pad - Anti Skid | 1 | |
| 14 | R453009 | 01-166-0400, 24-10-BD, 24-9-AD, 32-9650, 3256-2, 3256-23, 3256-3, 3256-67, 3290-217, 3556-3, 4-2390, 7-0152 | Washer - Flat 5/16 SAE | 3 | |
| 15 | R2412-103 | 2412-103 | Clamp | 1 | |
| 16 | R3229-1 | 01-173-0406, 01-178-0408, 3229-1, 3229-25, 900015P | Bolt - 1/4-20 x 3/4 - Carriage | 2 | |
| 17 | R93-2092 | 93-2092 | Clamp - Cable | 1 | |
| 18 | R330748 | 3274-22, 330748 | Screw - 5/16-18x1 Socket HD | 1 | |

All original equipment manufacturers names and part numbers are used for identification purposes only, and we are in no way implying that our products are original equipment parts. Prices subject to change without notice.



Replaces Toro Reelmaster 3100-D Parts

Traction Unit - Model 03200

Front Platform



| Item No | R&R Part No. | OEM Part No. | Description | Qty Req | Order Quantity |
|---------|------------------|--|----------------------------------|---------|----------------|
| 19 | R443106 | 01-188-0518, 22-12-AJD, 32111-4, 3217-4, 3217-6, 3218-2, 513295, 513412, 915112P, 915978, 915979 | Nut - 5/16-18 Y/Zinc Plated | 1 | |
| 20 | R3234-5 | 3234-5, 62-3310 | Bolt - 5/16-18x3/4 Hx Ser Was HD | 11 | |
| 21 | R74-9110 | 74-9110 | Rubber Foot Pad - Reverse | 1 | |
| 22 | R99-3379 | 99-3379 | Pedal - Reverse | 1 | |
| 23 | R99-3476 | 99-3476 | Spring - Extension | 1 | |
| 24 | R3296-47 | 3296-47 | Locknut - 5/16-18 Jam Nyloc | 3 | |
| 25 | R32151-84 | 32120-3, 32120-80, 32151-84 | Ring - Shaft - Ext | 2 | |
| 26 | R455012 | 3256-26, 41-8440 | Washer - Flat 1/2 x 3/4 | 1 | |
| 27 | R256-243 | 256-243 | Bearing - Flange | 4 | |
| 28 | R75-5470 | 75-5470 | Spacer - Bearing | 1 | |
| 29 | R251-259 | 251-259, 251-307 | Bearing - Ball | 1 | |
| 30 | R322-7 | 01-150-0750, 01-150-0760, 01-178-0512, 20-28-AD, 20-28-AGD, 322-7, 3223-4 | Bolt - Hex HD 5/16-18 x 1-1/2 | 1 | |

All original equipment manufacturers names and part numbers are used for identification purposes only, and we are in no way implying that our products are original equipment parts. Prices subject to change without notice.



Replaces Toro Reelmaster 3100-D Parts

Traction Unit - Model 03200

Front Platform



| Item No | R&R Part No. | OEM Part No. | Description | Qty Req | Order Quantity |
|---------|------------------|---|-------------------------------|---------|----------------|
| 31 | R74-9100 | 74-9100 | Rubber Foot Pad - Forward | 1 | |
| 32 | R100-4815 | 100-4815 | Cable - Traction Control | 1 | |
| 32 | R107-2550 | 107-2550, 93-2099 | Cable - Control - Traction | 1 | |
| 33 | R3230-23 | 3230-23, Mar-61 | Bolt - 5/16-18x3/4 - Carriage | 5 | |
| 34 | R3256-22 | 24-9-BD, 3-1032, 3256-1, 3256-22, 93-0954, 93-0989 | Washer - Flat 1/4 Yellow | 3 | |
| 35 | R3255-7 | 3255-7, 76-5310 | Washer - Lock 1/4 Ext Star Z | 2 | |
| 36 | R443102 | 01-188-0420, 22-11-AJD, 3217-5, 33024-00 | Nut - 1/4-20 Yellow Zinc | 2 | |
| 37 | R3229-20 | 3229-20 | Screw - 3/16-24 x 3/4 Carr | 1 | |
| 38 | R100-4872 | 100-4872, 104-7702 | Plate-Switch - Neutral | 1 | |
| 39 | R100-4871 | 100-4871 | Bracket - Neutral Switch | 1 | |
| 41 | R3256-14 | 24-7-BD, 32125-2, 3256-14, 3256-51, 51-2170 | Washer - 10 Flat | 1 | |
| 42 | R3255-17 | 3255-17 | Washer - Lock - Ext | 1 | |
| 43 | R3296-2 | 32127-10, 3296-2, 9157404 | Nut - #10 Lock | 1 | |
| 44 | R99-3565 | 99-3565 | Nut - Square | 1 | |

All original equipment manufacturers names and part numbers are used for identification purposes only, and we are in no way implying that our products are original equipment parts. Prices subject to change without notice.



Replaces Toro Reelmaster 3100-D Parts

Traction Unit - Model 03200

Front Platform



| Item No | R&R Part No. | OEM Part No. | Description | Qty Req | Order Quantity |
|---------|---------------------|--|--------------------------|---------|----------------|
| 45 | R106-2661-01 | 106-2661-01 | Plate - Support | 1 | |
| 46 | R95-8869-03 | 95-8869, 95-8869-03 | Bracket - Traction Pedal | 1 | |
| 47 | R73-0040 | 73-0040 | Washer - Thrust | 1 | |
| 48 | R95-8861 | 95-8861 | Slide | 1 | |
| 49 | R106-4154 | 106-4154 | Floorplate Assy | 1 | |
| 50 | R3296-29 | 1-804256, 3290-357, 3296-29, 915662P | Locknut - 5/16-18 ESNA | 1 | |
| 51 | R95-8866 | 95-8866 | Tube- Rocker Arm | 1 | |
| 53 | R65-9940 | 65-9940 | Spring | 1 | |
| 54 | R322-41 | 322-41 | Bolt - Hx HD | 1 | |
| 55 | RP457-2 | 01-191-0518, 22-12-AJK, 3218-2, 513299, P457-2 | Nut - Jam 5/16-18 Zinc | 1 | |
| 56 | R301504 | 2296-42, 301504, 32127-24, 32128-33, 32146-17, 3296-16, 3296-42, 3296-42 , 915661P | Locknut - ESNA 1/4-20 | 1 | |
| 57 | R104-4852-03 | 104-4852-03, 99-3564 | Traction Pedal Assy | 1 | |
| 58 | R99-3545 | 99-3545 | Spacer | 1 | |

All original equipment manufacturers names and part numbers are used for identification purposes only, and we are in no way implying that our products are original equipment parts. Prices subject to change without notice.



Replaces Toro Reelmaster 3100-D Parts

Traction Unit - Model 03200

Front Platform



| Item No | R&R Part No. | OEM Part No. | Description | Qty Req | Order Quantity |
|---------|-----------------|--|---------------------------|---------|----------------|
| 59 | R24M7139 | 24M7139, 3256-16, 33093-00, 43-5930 | Washer - Flat 6mm | 3 | |
| 60 | R2411-41 | 2411-41 | Rod End - Ball Joint | 1 | |
| 61 | R322-10 | 20-30-AD, 24-7180, 322-10, 322-10 , 3223-6, 513347 | Bolt - Hex HD 5/16-18 x 2 | 2 | |
| 62 | R32151-3 | 32151-3 | Ring - Grip | 1 | |
| 63 | R76-8870 | 105-7280, 76-8870 | Lever Damper Assy | 1 | |
| 64 | R95-8893 | 95-8893 | Bar - Deflector | 1 | |
| 65 | R302-5 | 21-6010, 302-11, 302-37, 302-47, 302-5, 302-57, 302-58, 302-6, 31-0300, 32-9660, 60-0800, 62-3880, 92-4181 | Fitting - Grease | 1 | |

All original equipment manufacturers names and part numbers are used for identification purposes only, and we are in no way implying that our products are original equipment parts. Prices subject to change without notice.