

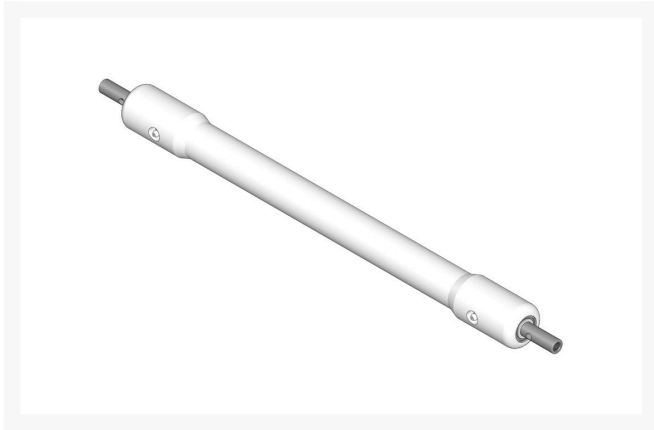

Roller - Swaged Machined Solid Aluminum

R21-6470



Details

Constructed with "water-pump" style bearings, this roller is machined from solid aluminum and contacts the ground only on the outer 2-7/8" of the roller.

Replaces

R&R Products	R10-5000, R52-3590
Toro	10-5000, 21-6470, 52-3590

Specifications

Manufacturer	R&R Products
Overhaul Kit No.	R107-1588
Roller Body	2 in
Diameter	
Weight (lbs)	4 lb

Fits Models

R&R Products Greens Max 2200LP
R&R Products Versa-Green 1860
R&R Products Versa-Green 1860PS
Toro Greensmaster 1000
Toro Greensmaster 1010
Toro Greensmaster 2000
Toro Greensmaster 3
Toro Greensmaster 300
Toro Greensmaster 3000
Toro Greensmaster 3050
Toro Greensmaster 3100
Toro Greensmaster 3150-Q
Toro Greensmaster Series 4

O.J. Company

294 Rang St-Paul Sherrington, J0L 2N0
450-247-2758

<https://ojcompagnie.rrproducts.com/>



Roller - Swaged Machined Solid Aluminum

R21-6470



Replacement Parts

R107-1588

R52-3180

R302-5

Overhaul Kit - Roller

Bearing - Front Roller

Fitting - Grease

O.J. Company

294 Rang St-Paul Sherrington, J0L 2N0
450-247-2758

<https://ojcompagnie.rrproducts.com/>