

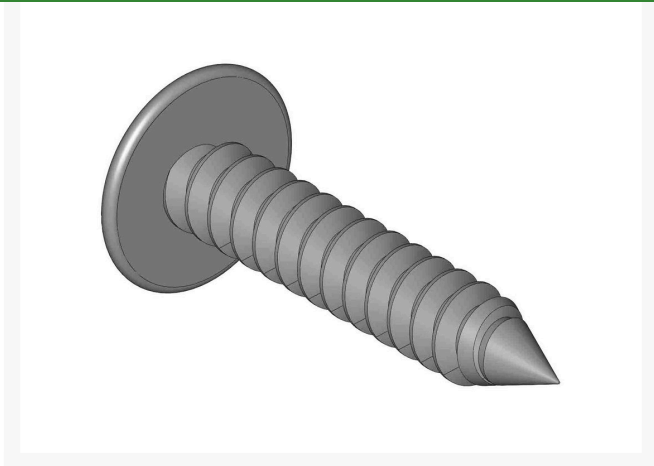

Pem Screws - 1 in Stainless Steel w/Black Coating

RPEM1150



Details

Fasten PEM matting to wood surface with 1" stainless steel screws. Recommended screw count using 6" centers with screws around perimeter for a 2' x 25' roll = 108 screws, 3' x 25' roll = 112 screws, 6' x 25' roll = 124 screws. Available in stainless steel or stainless steel with black coating. Sold in box of 100.

Specifications

Manufacturer	PEM
--------------	-----

O.J. Company

294 Rang St-Paul Sherrington, J0L 2N0
450-247-2758

<https://ojcompagnie.rrproducts.com/>